

ROOFTOP UNIT



Energy recovery core is AHRI Certified®



SPECIFICATIONS

Ventilation Type: Static plate, heat and humidity transfer

Typical Airflow Range: 2,000–8,800 CFM

AHRI 1060 Certified Core: Ten L125-G5

Standard Features:

- TEFC Premium efficiency motors
- Motor starters
- Non-fused disconnect
- 24VAC transformer/relay package
- Cross-core differential pressure ports
- Independent blower control

Filters: Total qty. 12, MERV 8: 20" x 25" x 2"

Unit Weight:

- Modular (per module) 1,311–1,806 lbs., varies by option(s)
- Assembled (1-piece) 2,631–3,453 lbs., varies by option(s)

Max. Shipping Dimensions & Weight (on pallet):

- Modular (2-modules) 80" L x 90" W x 78" H
- Module 1: 1,986 lbs., Module 2: 1,917 lbs.
- Assembled (1-piece) 200" L x 90" W x 78" H; 3,812 lbs.

Motor(s):

- Qty. 2, Belt drive blower/standard motor packages with choice of adjustable sheaves (see table below)

Options:

- Spring vibration isolators
- Ultra premium efficiency (IE5+) motors with variable frequency drives (VFDs): both airstreams
- Onboard VFDs: both airstreams
- Shaft grounding ring on motors with VFDs
- Fused disconnect
- Integrated programmable controls: enhanced, premium
- Class 1 low leakage motorized isolation dampers: FA, EA or both airstreams
- Factory mounted filter alarms: both airstreams
- Double wall construction
- Exterior paint - white, custom colors

Accessories:

- Filters: MERV 13, 2" (shipped loose)
- Automatic balancing damper: 4", 5", 6"
- Roof curb: standard 14"
- Curb wind clip
- Digital time clock: wall mount (TC7D-W), in exterior enclosure (TC7D-E)
- Carbon dioxide sensor/control: wall mount (CO2-W), duct mount (CO2-D)
- IAQ sensor: wall mount (IAQ-W), duct mount (IAQ-D)
- Motion occupancy sensor/control: ceiling mount (MC-C), wall mount (MC-W)
- Smoke Detector: duct mount (SD-D)
- BACnet fan control: wall mount (BACNETFC-W)
- Indoor electric duct heater: EK series (1–175 kW);
- Indirect gas-fired duct furnace: GH series (50–400 MBH); Installed downstream of any fans

AIRFLOW PERFORMANCE

Airflow CFM	LE10XRT External Static Pressure (in.w.g.)																			
	0.00		0.25		0.50		0.75		1.00		1.25		1.50		1.75		2.00			
	BHP	RPM	BHP	RPM	BHP	RPM	BHP	RPM	BHP	RPM	BHP	RPM	BHP	RPM	BHP	RPM	BHP	RPM		
							3 HP LOW SPEED				3 HP MED SPEED		3 HP HIGH SPEED							
2500							1.1	710	1.3	790	1.6	870	1.8	930	2.1	1000	2.4	1050		
3000					1.0	640	1.3	730	1.5	810	1.8	880	2.0	950	2.3	1010	2.6	1070		
3500					1.2	660	1.4	750	1.7	830	2.0	900	2.3	960	2.6	1020	2.9	1080		
4000					1.4	680	1.6	770	1.9	840	2.2	910	2.5	980	2.9	1040	3.2	1100		
4500					1.6	710	1.9	790	2.2	860	2.5	930	2.8	990	3.2	1050	3.5	1110		
5000			1.6	670	1.9	740	2.1	810	2.5	880	2.8	940	3.1	1000	3.5	1060	3.9	1120	5 HP HIGH SPEED	
5500	3 HP LOW SPEED	1.6	640	1.9	710	2.2	770	2.5	840	2.8	900	3.1	960	3.5	1020	3.8	1080	4.2		1130
6000		2.0	690	2.2	750	2.5	810	2.8	870	3.1	920	3.5	980	3.9	1040	4.2	1090	4.6	1150	
6500	2.4	740	2.6	790	2.9	850	3.2	900	3.6	950	3.9	1000	4.3	1060	4.7	1110	5.1	1160	7.5 HP MED	
7000	2.8	790	3.1	830	3.4	880	3.7	930	4.0	980	4.4	1030	4.8	1080	5.2	1130	5.6	1170		
7500	5 HP LOW SPEED	3.3	830	3.6	880	3.9	920	4.2	970	4.6	1010	4.9	1050	5.3	1100	5.7	1140	6.1	1190	7.5 HP HIGH SPEED
8000	3.9	880	4.2	920	4.5	960	4.8	1000	5.1	1040	5.5	1080	5.9	1120	6.3	1160	6.7	1200		
8500	5 HP MED SPEED	4.5	930	4.8	960	5.1	1000	5.4	1030	5.8	1070	6.1	1100	6.5	1140	6.9	1180	7.3	1210	
9000	7.5 HP LOW SPEED	5.2	970	5.5	1000	5.8	1030	6.1	1060	6.4	1100	6.8	1130	7.1	1160	7.5	1190	7.9	1220	
9500		5.9	1010	6.2	1040	6.5	1060	6.8	1090	7.1	1120	7.5	1150	7.8	1180	8.2	1210	8.5	1230	
10000	6.7	1040	7.0	1070	7.3	1090	7.6	1120	7.9	1140	8.2	1170	8.5	1190	8.9	1220	9.2	1240	10 HP HIGH SPEED	
10500	7.5 HP MED SPEED	7.5	1080	7.8	1100	8.1	1120	8.4	1140	8.7	1160	9.0	1190	9.3	1210	9.6	1230	10.0		1250
11000			8.4	1100	8.6	1120	8.9	1140	9.2	1160	9.5	1180	9.8	1200						
	10 HP MED SPEED									10 HP HIGH SPEED										

Note: Airflow performance includes effect of clean, standard filter supplied with unit.



10XRT

ENERGY RECOVERY VENTILATOR



ELECTRICAL DATA

Electrical Specifications				Motor Starters (Standard)			Optional IE3 Efficiency Motor with VFDs			Optional IE5+ Efficiency Motor with VFDs		
HP	Volts	HZ	Phase	FLA per Motor	Min. Cir. Amps	Max. Overcurrent Protection Device	FLA per Motor	Min. Cir. Amps	Max. Overcurrent Protection Device	FLA per Motor	Min. Cir. Amps	Max. Overcurrent Protection Device
3.0	208-230	60	Single	14.6-14.0	32.9	45.0	9.0-8.4	35.1	50.0	7.3-7.3	28.4	40.0
3.0	208-230	60	Three	9.0-8.4	20.3	25.0	9.0-8.4	20.3	25.0	7.3-7.3	16.4	20.0
	460	60	Three	4.2	9.5	15.0	4.2	9.5	15.0	3.7	8.3	15.0
	575	60	Three	3.3	7.4	15.0	3.3	7.4	15.0			
5.0	208-230	60	Three	13.9-13.4	31.3	45.0	13.9-13.4	31.3	45.0	10.5-10.5	23.6	30.0
	460	60	Three	6.7	15.1	20.0	6.7	15.1	20.0	5.3	11.9	15.0
	575	60	Three	5.3	11.9	15.0	5.3	11.9	15.0			
7.5	208-230	60	Three	20.0-19.0	45.0	60.0	20.0-19.0	45.0	60.0	17.4-17.4	39.2	50.0
	460	60	Three	9.5	21.4	30.0	9.5	21.4	30.0	8.7	19.6	25.0
	575	60	Three	7.6	17.1	20.0	7.6	17.1	20.0			
10.0	208-230	60	Three	25.4-24	57.2	80	25.4-24	57.2	80	22.0-22.0	49.5	70
	460	60	Three	12	27.0	35	12	27.0	35	11	24.8	35
	575	60	Three	9.6	21.6	30	9.6	21.6	30			

LE10XRT (RTV/RTR) ENERGY RECOVERY VENTILATOR

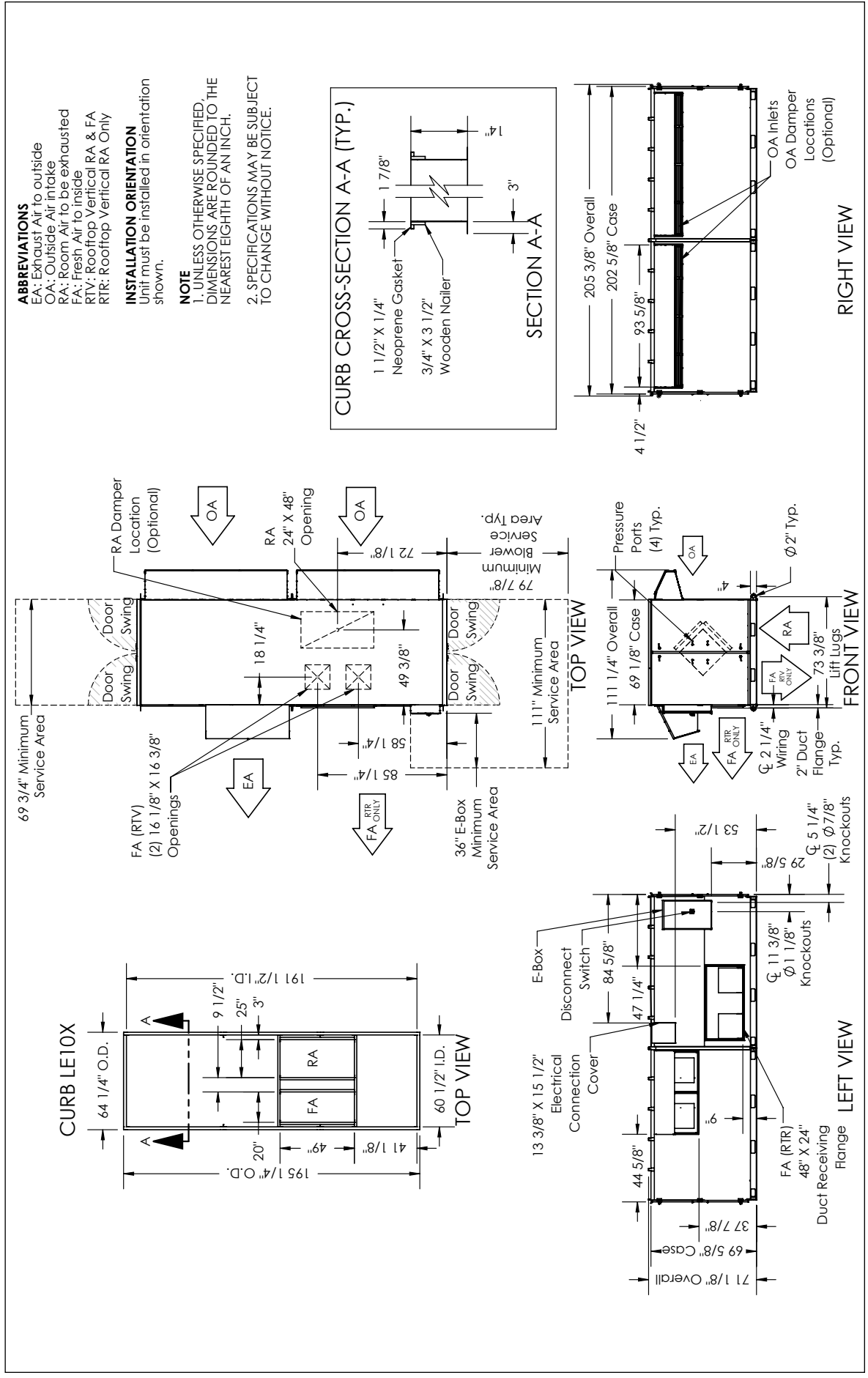

ABBREVIATIONS
 EA: Exhaust Air to outside
 OA: Outside Air Intake
 RA: Room Air to be exhausted
 FA: Fresh Air to inside
 RTV: Rooftop Vertical RA & FA
 RTR: Rooftop Vertical RA Only

INSTALLATION ORIENTATION
 Unit must be installed in orientation shown.

NOTE
 1. UNLESS OTHERWISE SPECIFIED, DIMENSIONS ARE ROUNDED TO THE NEAREST EIGHTH OF AN INCH.
 2. SPECIFICATIONS MAY BE SUBJECT TO CHANGE WITHOUT NOTICE.

UNIT MOUNTING & APPLICATION
 Must be mounted as shown. Airstreams cannot be switched.



AIRFLOW ORIENTATION
 Available as shown in dimension drawing.

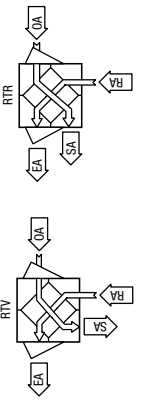

LE10XRT (RTH/RTF) ENERGY RECOVERY VENTILATOR

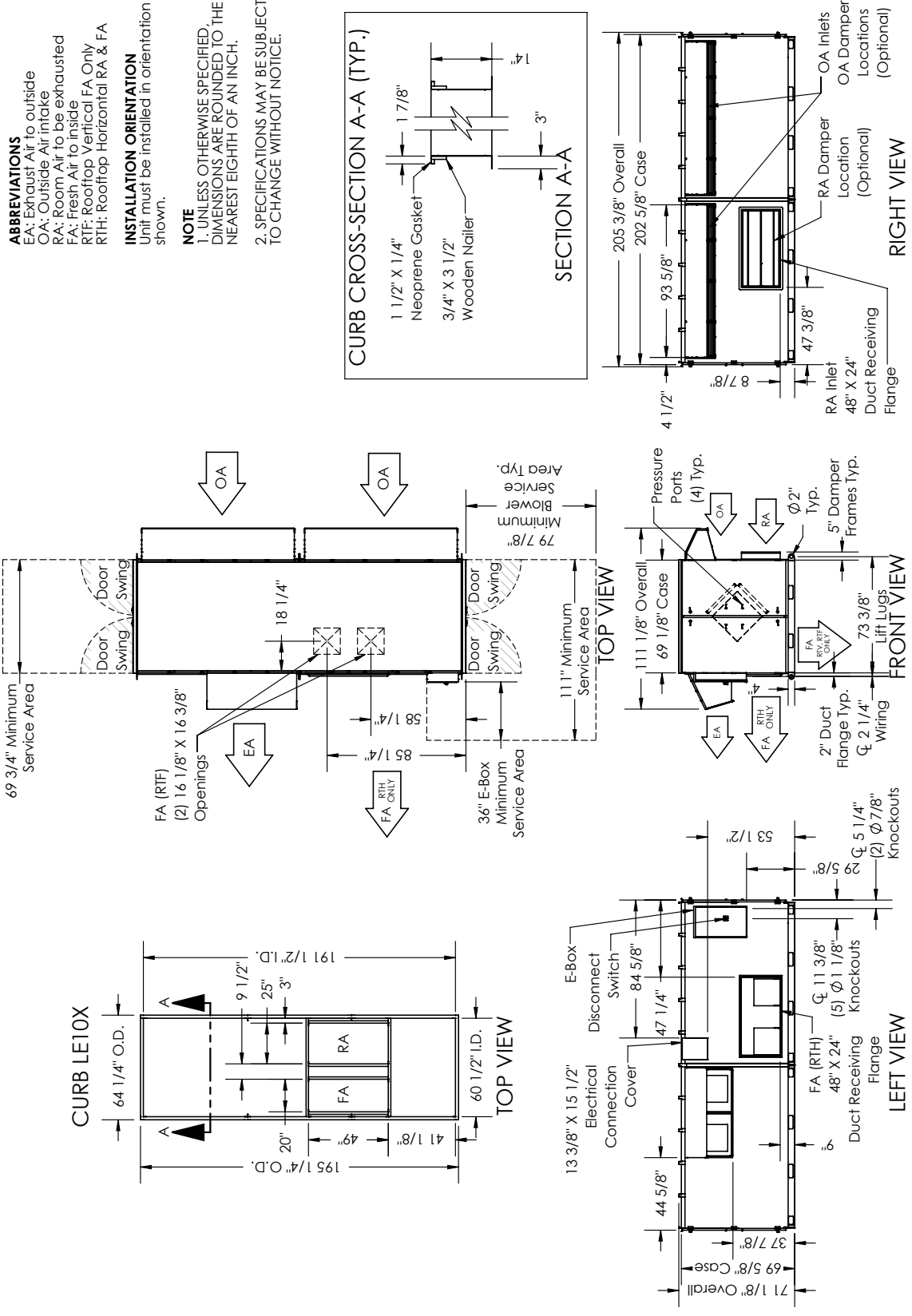

UNIT MOUNTING & APPLICATION
 Must be mounted as shown. Airstreams cannot be switched.



AIRFLOW ORIENTATION
 Available as shown in dimension drawing.

